

Notes to presenters

The sailing club provides high-definition projection with the ability to replicate the content on two TVs.

Speakers are encouraged to bring their own device. Connectivity can be via using the HDMI cable provided (this is connected to HDMI 2 on the projector) or wirelessly using any PC which is capable of MiraCast. For backwards compatibility there is a VGA socket (video only with no sound). Note the use of the VGA socket will provide a much poorer displayed image.

HDMI connectivity:

Plug the PC into the HDMI lead provided and select HDMI 2 using the remote. The projection is in 16:9 format so all PowerPoint slides need to be 16:9 format. The system is designed to bring your own device and works best if your system display is set to duplicate rather than extended as otherwise the projector will be treated as a separate monitor.

Wireless Connectivity

The projector is Miracast enabled meaning most windows 10 users and Mac users will be able to wirelessly connect to the projector. Click on the far-right hand side of the system tray

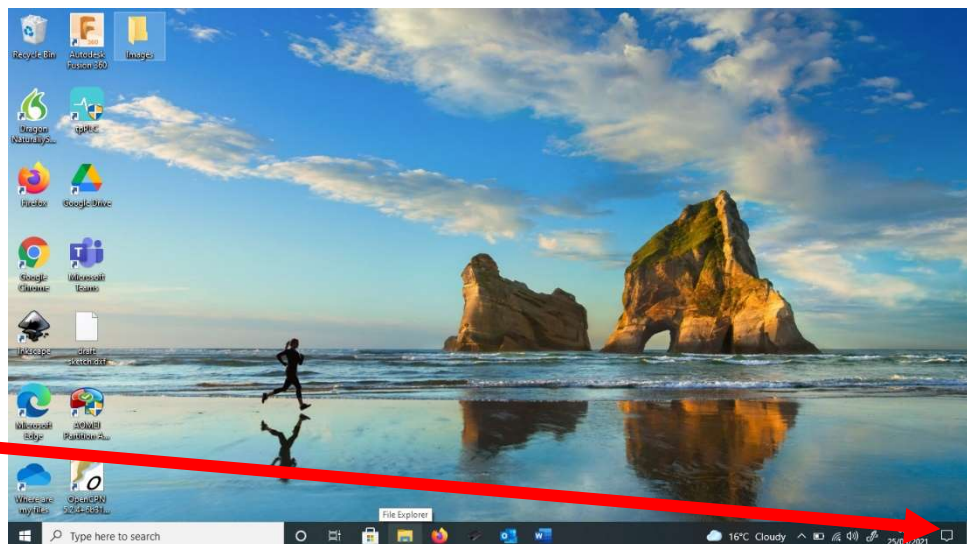

Then click on Connect and find the projector on the list of devices provided

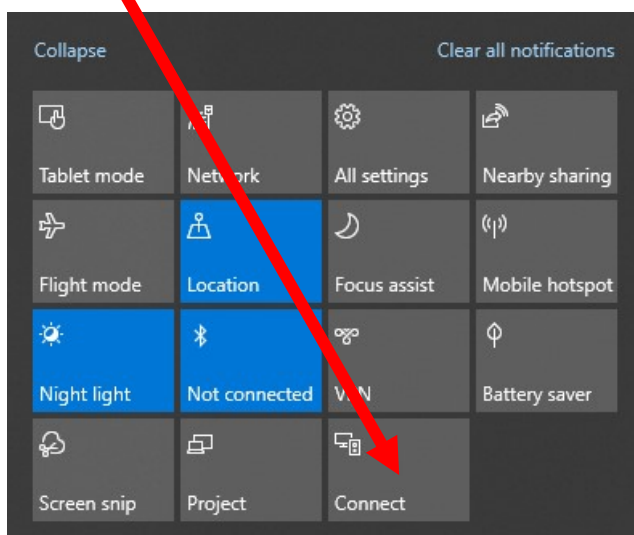

Speakers who have their presentation on a memory stick and have no laptop

The club provides a Dell Chromebook. Speakers just need to plug the Chromebook into the HDMI socket and make sure the projector input HDMI 2 is selected. Speakers then need to plug their memory stick in the Chromebook USB socket and follow the on-screen prompts. Speakers just need to double click on their presentation for it to be opened in Google slides. From this point the presentation will mirror a standard PowerPoint presentation.